

Standard – Quick-Disconnect Coupling of Series STG

DN 32 to DN 60 (G/NPT)

Non shut-off version

Technical Data of Series STG		
Series	Nominal diameter	Permissible operating pressure [bar]*
		VA
STG10	DN 32	63
STG12	DN 40	50
STG16	DN 50	40
STG20	DN 60	30

VA = stainless steel

*static, coupled at 20° C

Options	
Materials	Seals
<ul style="list-style-type: none"> · Stainless steel (1.4305, 1.4404) · Hastelloy® C-276 	<ul style="list-style-type: none"> · NBR · FPM · EPDM · CR · FVMQ · PTFE · FFKM · etc. (also FDA-compliant)
Temperature range -80°C to +325°C (depending on type of seal)	

Coupling series ST is of extremely robust design. It proves especially useful if the flow of highly viscous media (e.g. grease) and must be ensured that a shut-off function is not required.

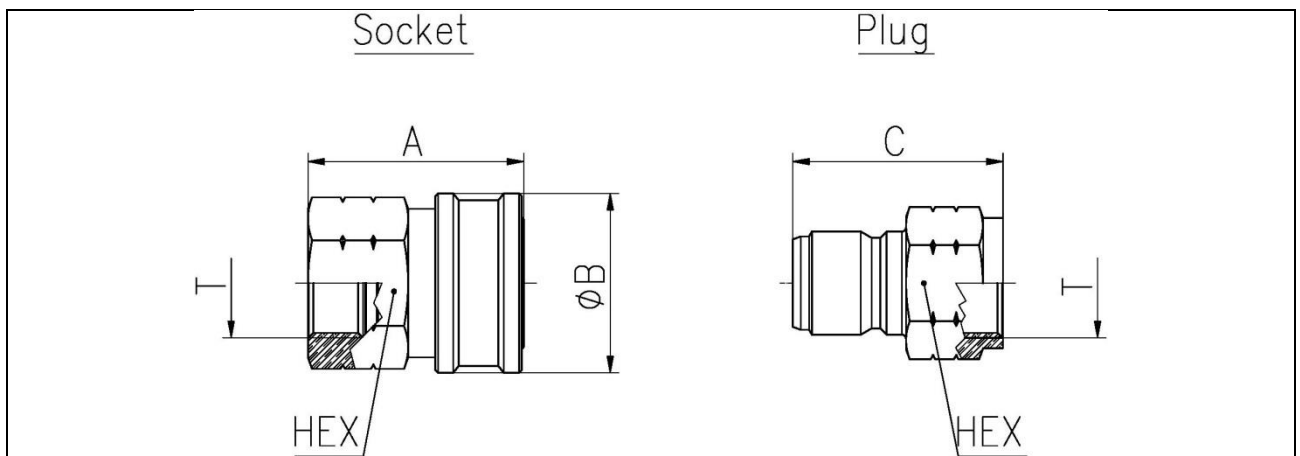

Dimensions Series STG						
Series	T Thread *	A [mm]	B [mm]	C [mm]	Width across flats	
					Socket	Plug
					[mm]	
STG10	1 1/4	64	64	64	50	50
STG12	1 1/2	73	79	73	65	60
STG16	2	84	95	83	80	70
STG20	2 1/2	87	114	86	90	85

Subject to technical alterations, errors and misprints excepted

* Chart for G and NPT

