

Standard – Quick-Disconnect Coupling of Series STG

DN 4 to DN 25 (G/NPT)

Non shut-off version

Technical Data of Series STG		
Series	Nominal diameter	Permissible operating pressure [bar]*
		VA
STG1	DN 4	290
STG2	DN 6	515
STG3	DN 10	430
STG4	DN 12	245
STG6	DN 20	205
STG8	DN 25	135

VA = stainless steel

*static, coupled at 20° C

Options	
Materials	Seals
· Stainless steel (1.4305, 1.4404)	· NBR · FPM · EPDM · CR · FVMQ · PTFE · FFKM · etc. (also FDA-compliant)
· Hastelloy® C-276	
Temperature range	
-80°C to +325°C (depending on type of seal)	

Coupling series ST is of extremely robust design. It proves especially useful if the flow of highly viscous media (e.g. grease) and must be ensured that a shut-off function is not required.

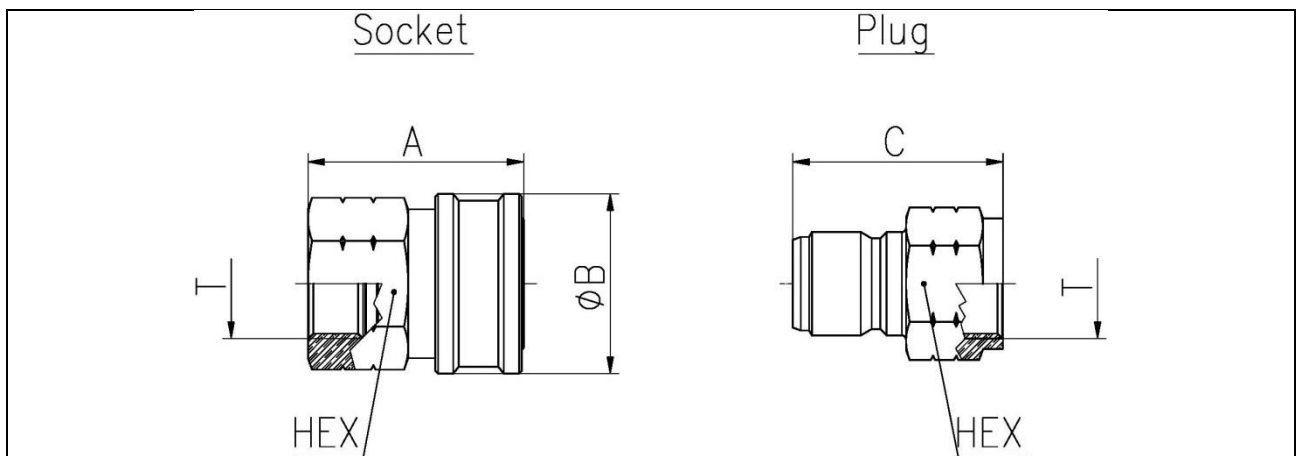

Dimensions Series STG						
Series	T Thread*	A [mm]	B [mm]	C [mm]	Width across flats	
					Socket	Plug
					[mm]	
STG1	1/8	27	18	25	14	14
STG2	1/4	38	25	37	22	19
STG3	3/8	41	28	42	27	22
STG4	1/2	49	34	49	30	27
STG6	3/4	52	44	51	36	32
STG8	1	59	51	57	46	41

Subject to technical alterations,
errors and misprints excepted

* Chart for G and NPT

